



Issaquah Commons is an open-air community shopping center located on a primary retail street in one of the Seattle area's fastest growing markets.



THE PROJECT

- 372,390-square-foot, open-air community shopping center
- Anchored by Target, REI, Safeway, Trader Joe's, Ross Dress for Less, Bed Bath & Beyond and Petco
- Featuring Chico's, Starbucks, WildFin American Grill, Justice for Girls and Panera Bread
- Located 20 miles east of Seattle and 8 miles east of Bellevue, Issaquah serves as the retail hub for the spectacular growth along the I-90 corridor and farther East



755 NW Gilman Boulevard
Issaquah, WA 98027

DEMOGRAPHICS

1 MILE

3 MILE

5 MILE

Population	6,575	55,719	120,009
Households	2,995	21,888	43,950
HH Income	\$118,288	\$147,728	\$171,830

Source: SitesUSA 2017

LEASING

Richard Wolf
213-793-1010
Richard.Wolf@MadisonMarquette.com

ONLINE

issaquahcommons.com

[@issaquahcommons](https://twitter.com/issaquahcommons)

facebook.com/IssaquahCommons



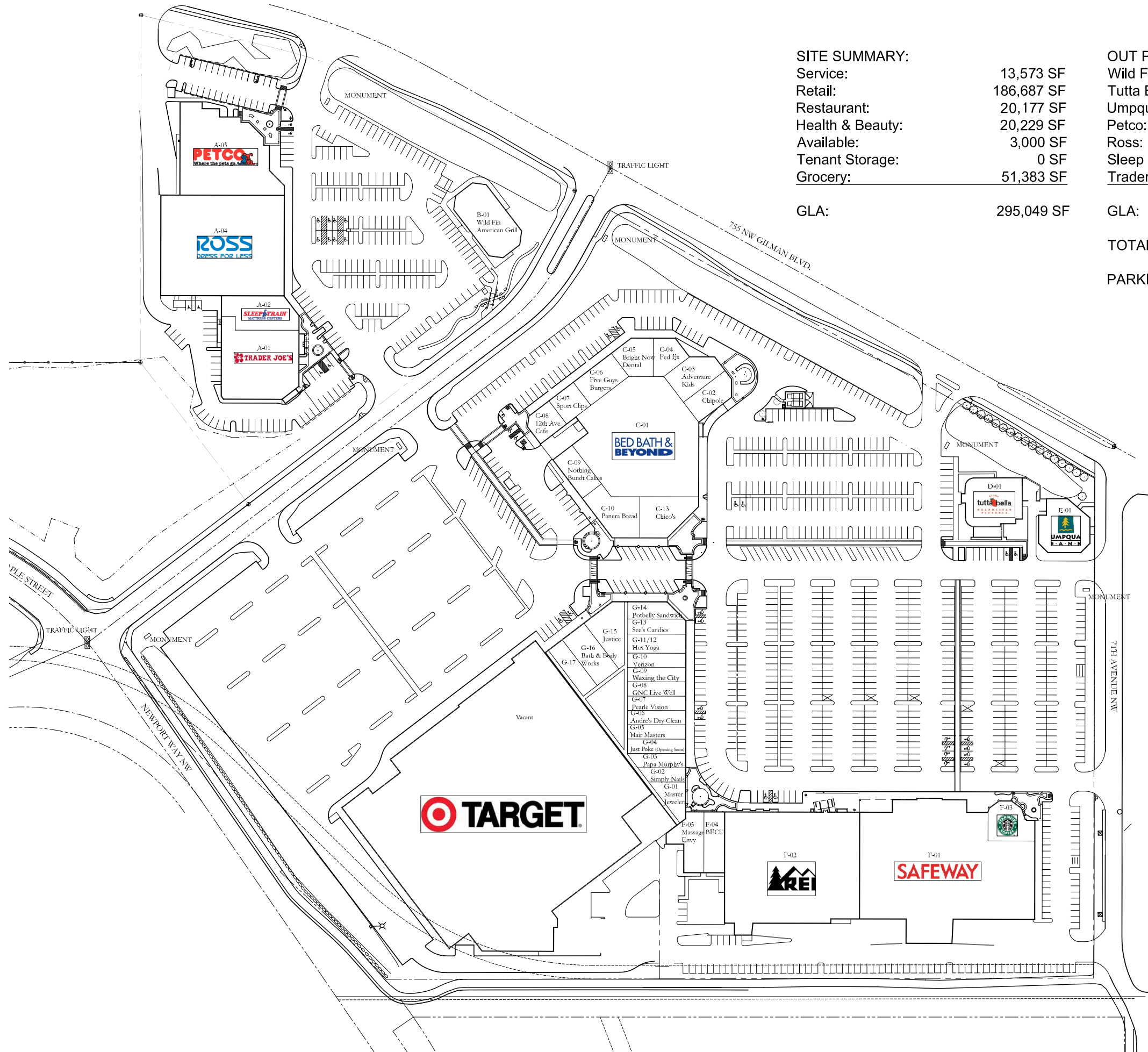

SITE SUMMARY:

Service:	13,573 SF
Retail:	186,687 SF
Restaurant:	20,177 SF
Health & Beauty:	20,229 SF
Available:	3,000 SF
Tenant Storage:	0 SF
Grocery:	51,383 SF

GLA: 295,049 SF

OUT PARCELS:

Wild Fin American Grill:	6,600 SF
Tutta Bella:	5,693 SF
Umpqua Bank:	5,000 SF
Petco:	15,711 SF
Ross:	27,194 SF
Sleep Train:	5,128 SF
Trader Joe's:	12,015 SF

GLA: 77,341 SF

TOTAL GLA: 372,390 SF

PARKING SPACES: 1,233 Stalls

SITE PLAN
 10/31/17

This plan is for the purpose of the building and general management only. It is not intended as an instrument of service. It is not intended to be used as a representation of the actual construction or any other information that may be required for the construction of the project. It is not intended to be used as a representation of the actual construction or any other information that may be required for the construction of the project.

ISSAQUAH COMMONS
 755 NW Gilman Blvd.
 Issaquah, WA



Richard M. Wolf, CRX-CLS
 Senior Vice President, Leasing
 Callie Broderick # 01613121
 rwolf@mmms.com
 Office: 323,802,5312
 Mobile: 213,783,1010

MadisonMarquette
 madisonmarquette.com

CHANDLER STEVER ARCHITECT
 1152 228th St. NE
 SAMMAMISH, WA 98076
 TEL: 206-885-9278
 FAX: 206-885-9279
 EMAIL: CHANDLERSTEVE@GMAIL.COM



OVERALL SITE PLAN

NOT TO SCALE

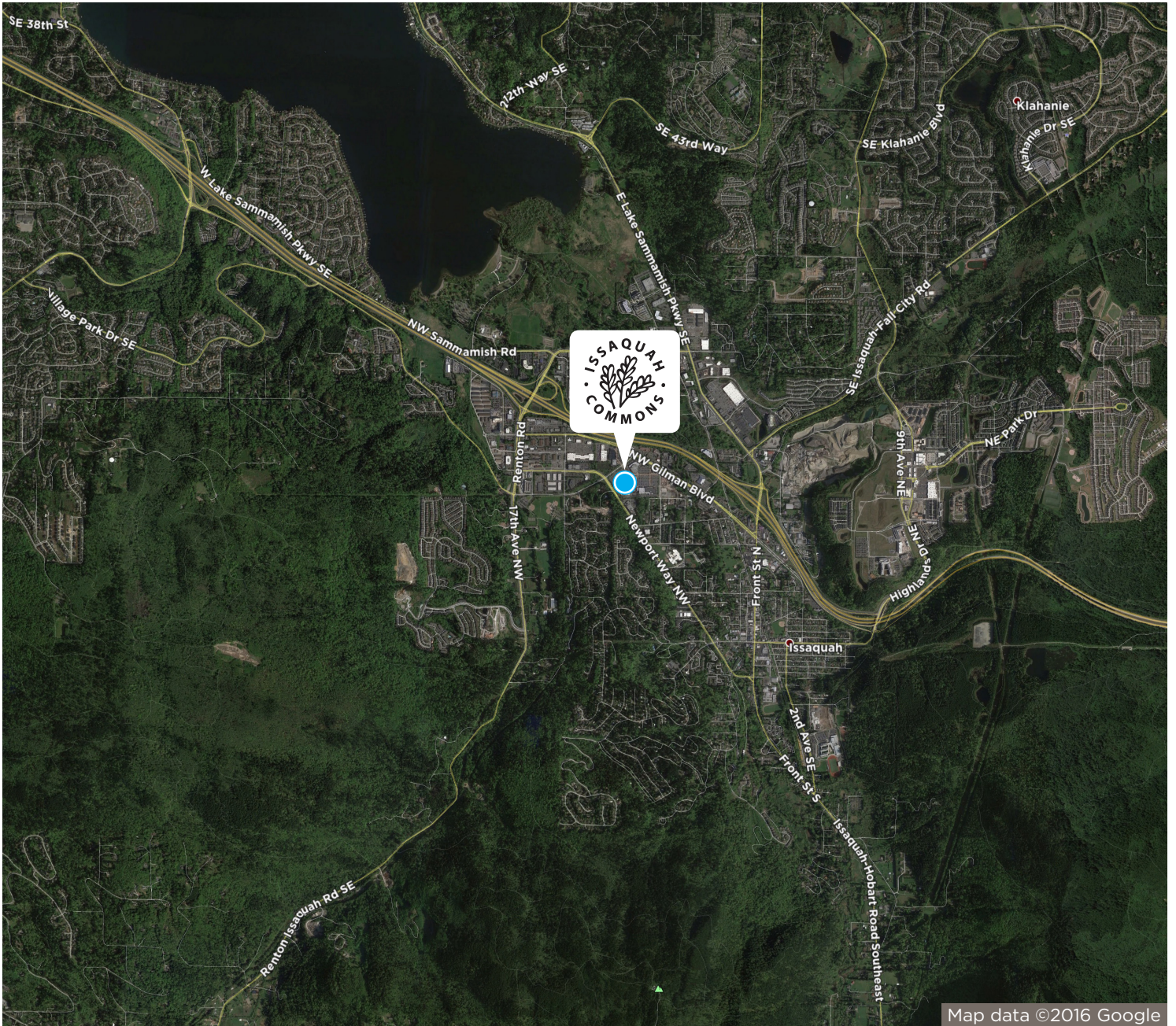

LEASING

Richard Wolf • 213-793-1010 • Richard.Wolf@MadisonMarquette.com

