



Chesterfield MALL

Chesterfield Mall is a super-regional, two-level enclosed mall located in the west suburbs of St. Louis, MO.



THE PROJECT

- This 1,293,445 square foot property is anchored by Dillard's, Macy's, and Sears.
- Boasts many specialty retailers and restaurants such as Cheesecake Factory, LOFT, Francesca's Collection and AMC Theaters.
- Area is home to the state's top-rated public schools.
- Population growth within a 1 mile radius of Chesterfield Mall is predicted to increase 1.3% by 2020.

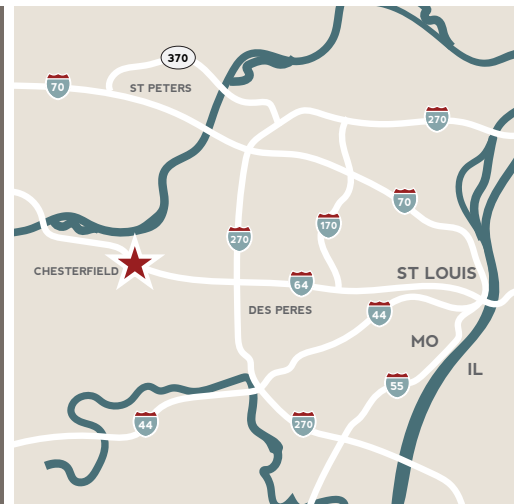

291 Chesterfield Mall
Chesterfield, MO 63017

DEMOGRAPHICS

1 MILE

3 MILE

5 MILE

Population	7,185	46,338	113,813
Households	3,476	18,923	44,901
HH Income	\$111,128	\$158,644	\$154,766

Source: SitesUSA 2017

LEASING

Richard Wolf
323-602-5312
Richard.Wolf@MadisonMarquette.com

ONLINE

chesterfield-mall.com

facebook.com/ChesterfieldMall



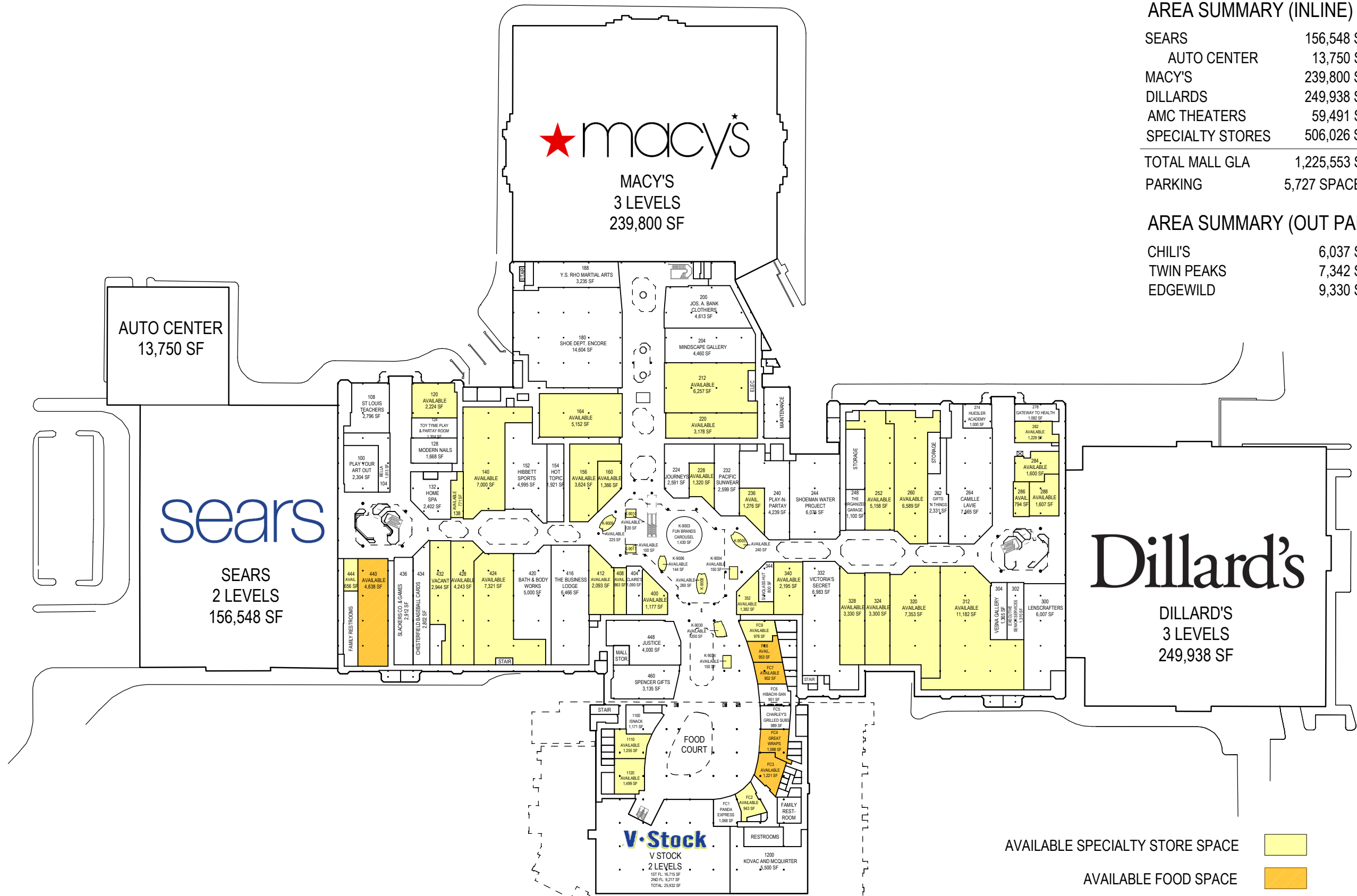

AREA SUMMARY (INLINE)

SEARS	156,548 SF
AUTO CENTER	13,750 SF
MACY'S	239,800 SF
DILLARDS	249,938 SF
AMC THEATERS	59,491 SF
SPECIALTY STORES	506,026 SF
TOTAL MALL GLA	1,225,553 SF
PARKING	5,727 SPACES

AREA SUMMARY (OUT PARCELS)

CHILI'S	6,037 SF
TWIN PEAKS	7,342 SF
EDGEWILD	9,330 SF



For Leasing Inquiries:
 Richard Wolf
 O/323-602-5312 M/213-793-1010
 Richard.Wolf@MadisonMarquette.com
 www.madisonmarquette.com

291 CHESTERFIELD MALL, CHESTERFIELD, MO 63017 636-532-4004

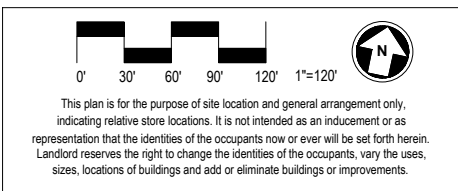

**LEASE PLAN
 LOWER LEVEL**
 04/12/18

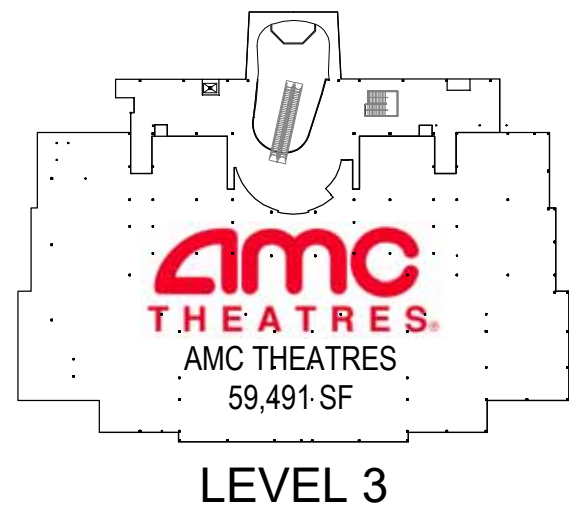
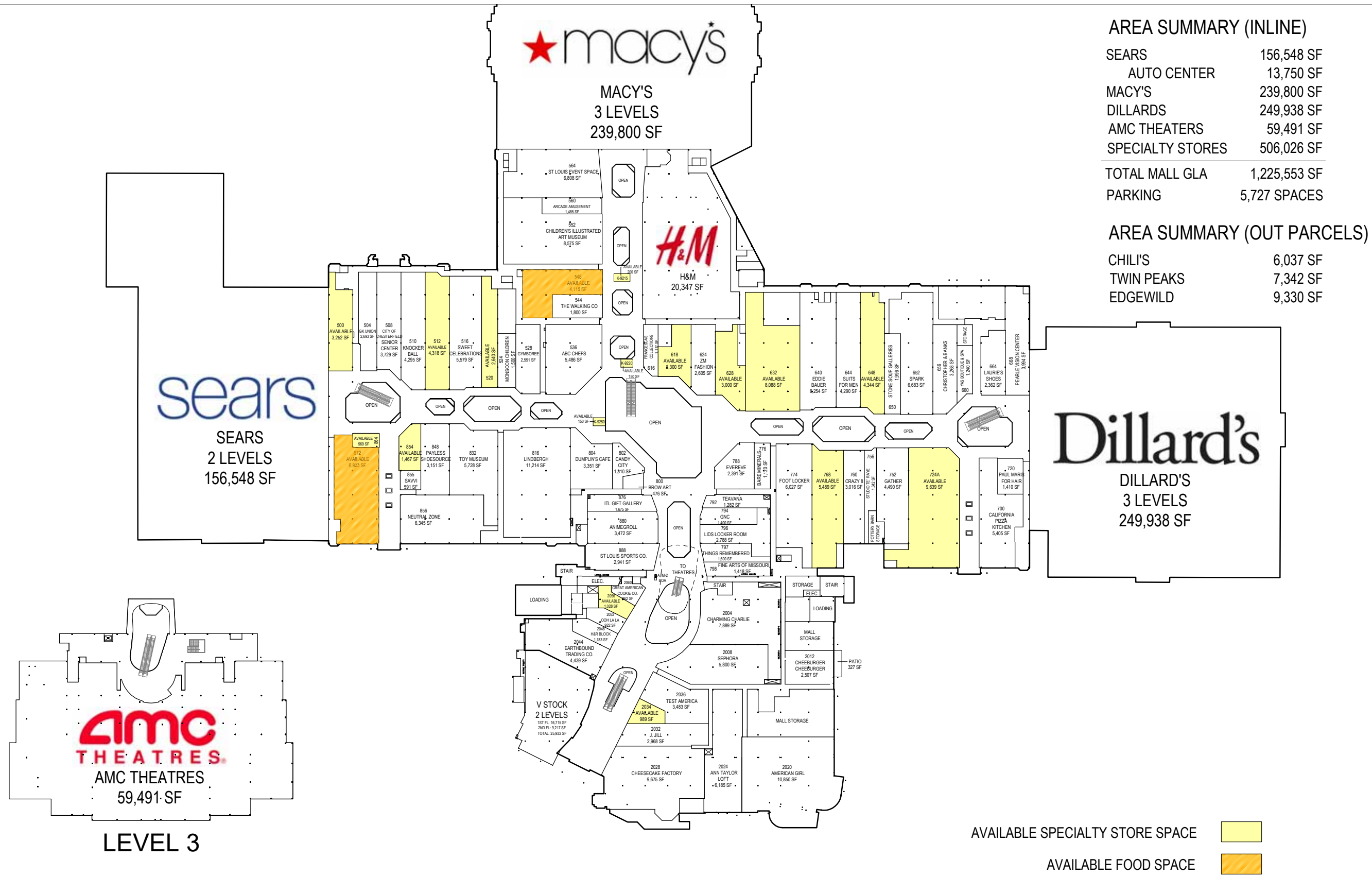

AVAILABLE SPECIALTY STORE SPACE
 AVAILABLE FOOD SPACE



For Leasing Inquiries:
 Art Butterfield
 O/ 202-730-2014 M/202-909-5312
 Art.Butterfield@MadisonMarquette.com
 www.madisonmarquette.com

Chesterfield
 MALL
 291 CHESTERFIELD MALL, CHESTERFIELD, MO 63017 636-532-4004

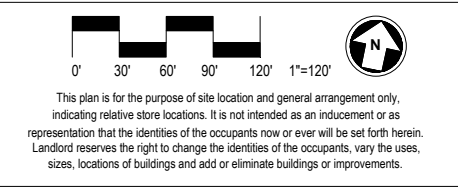

LEASE PLAN
UPPER LEVEL
 02/12/17

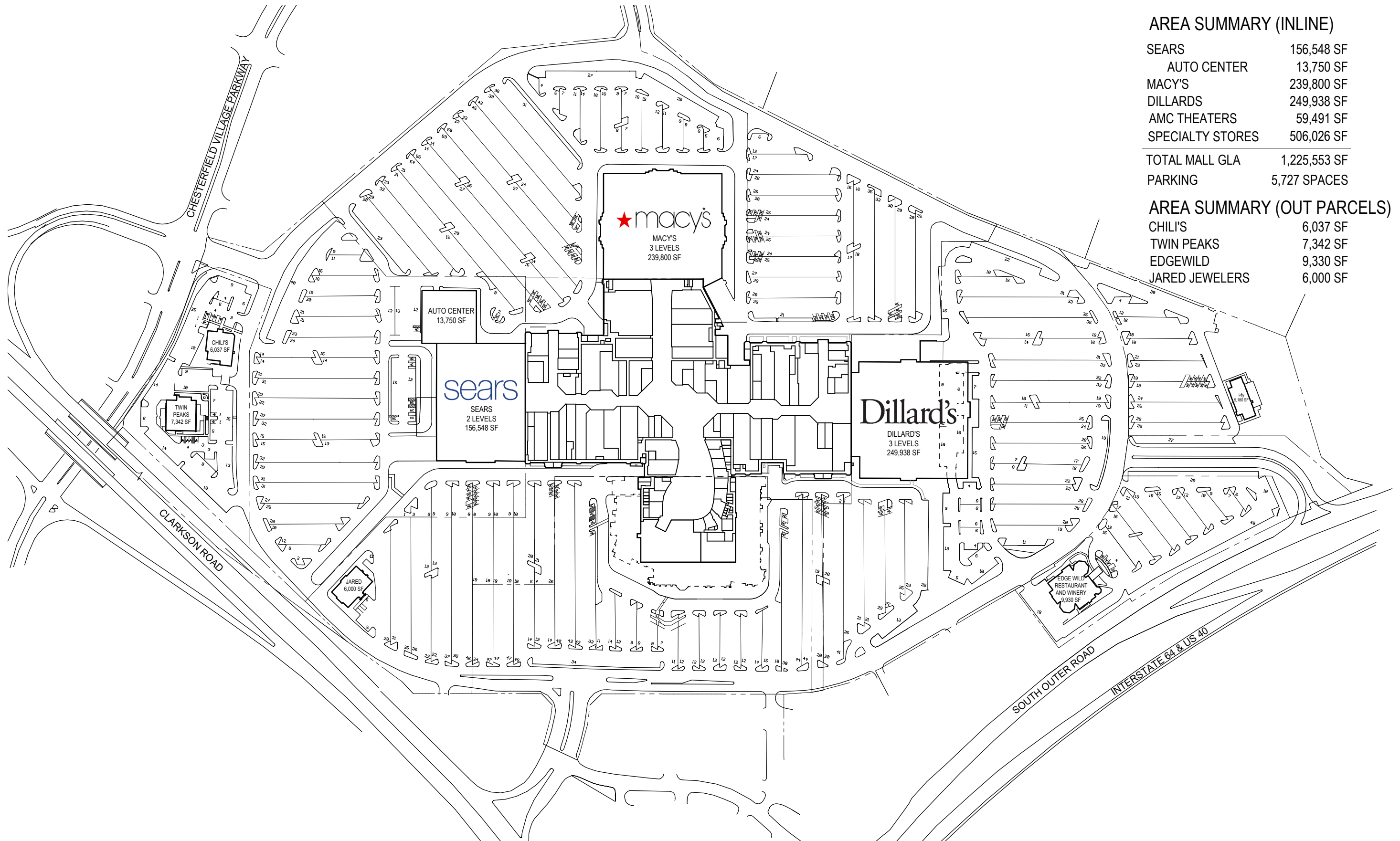

AREA SUMMARY (INLINE)

SEARS	156,548 SF
AUTO CENTER	13,750 SF
MACY'S	239,800 SF
DILLARDS	249,938 SF
AMC THEATERS	59,491 SF
SPECIALTY STORES	506,026 SF
TOTAL MALL GLA	1,225,553 SF
PARKING	5,727 SPACES

AREA SUMMARY (OUT PARCELS)

CHILI'S	6,037 SF
TWIN PEAKS	7,342 SF
EDGEWILD	9,330 SF
JARED JEWELERS	6,000 SF



MadisonMarquette

For Leasing Inquiries:
Richard Wolf
O/323-602-5312 M/213-793-1010
Richard.Wolf@MadisonMarquette.com

www.madisonmarquette.com



Chesterfield
MALL

291 CHESTERFIELD MALL, CHESTERFIELD, MO 63017 636-532-4004

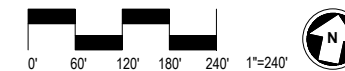

This plan is for the purpose of site location and general arrangement only, indicating relative store locations. It is not intended as an inducement or as representation that the identities of the occupants now or ever will be set forth herein. Landlord reserves the right to change the identities of the occupants, vary the uses, sizes, locations of buildings and add or eliminate buildings or improvements.

SITE PLAN
01/30/18

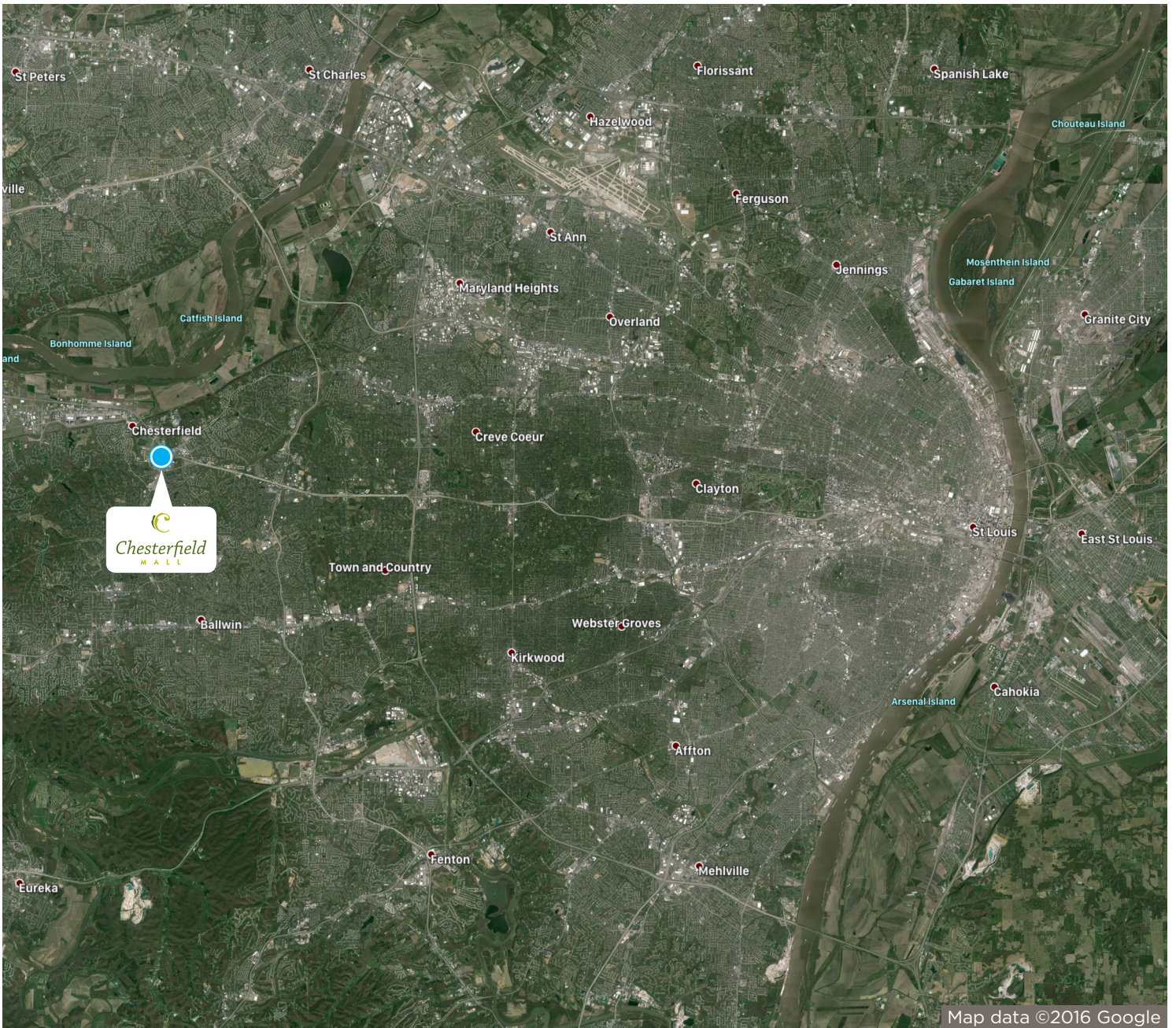

LEASING

Richard Wolf • 323-602-5312 • Richard.Wolf@MadisonMarquette.com

